

NOTES:

1. HOUSING: LCP HIGH-TEMP THERMOPLASTIC UL94V-0 COLOR: BEIGE
2. ACTUATOR: LCP HIGH-TEMP THERMOPLASTIC UL94V-0 COLOR: BEIGE
3. TERMINAL: PHOSPHOR BRONZE  
PLATING: CONTACT AREA AND SOLDER TAIL AREA GOLD PLATING1 $\mu$ MIN.  
OR 100~150 $\mu$ TIN(LEAD FREE) OVERALL 50~100 $\mu$ TINICKEL UNDER PLATED.
4. FITTING NAIL: BRASS  
PLATING: 100~150 $\mu$ TIN(LEAD FREE)  
OVERALL 50~100 $\mu$ NICKEL UNDER PLATED.
5. RATING:  
OPERATING VOLTAGE: 50V AC, DC  
CURRENT RATING: 0.5A AC, DC  
OPERATING TEMPERATURE: -25 $^{\circ}$ C~+85 $^{\circ}$ C

6. CODING INFORMATION: 5001 - FEZ 05 59 - \*\* R 1  
JMFPCC CONNECTOR SERIES  
PITCH: 0.5  
HIGH: 5.9  
ALTERNATE  
PACKING: R: 卷  
PIN

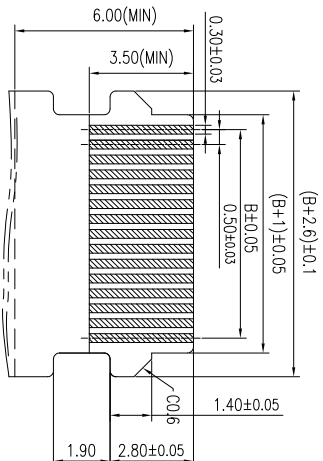
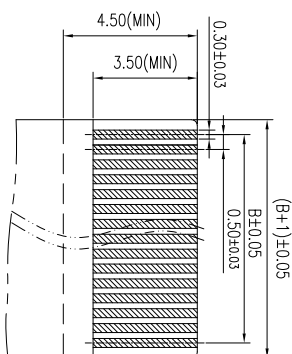
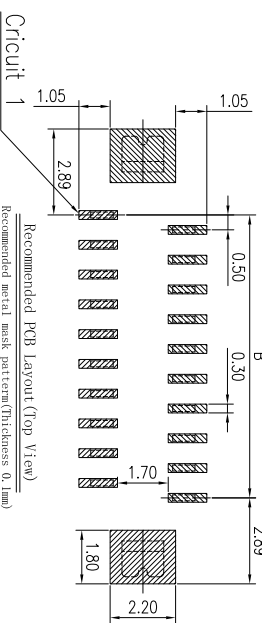
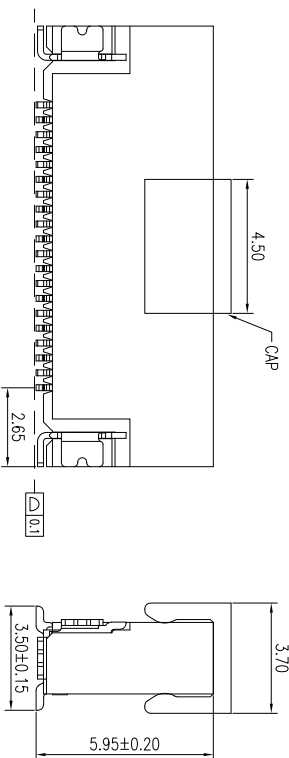
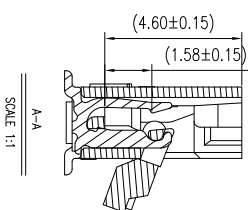
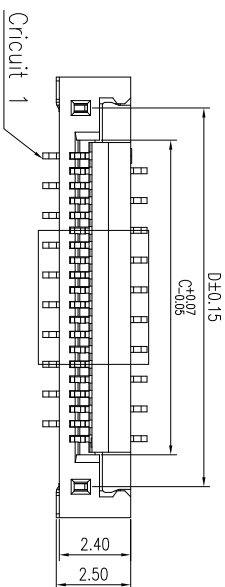
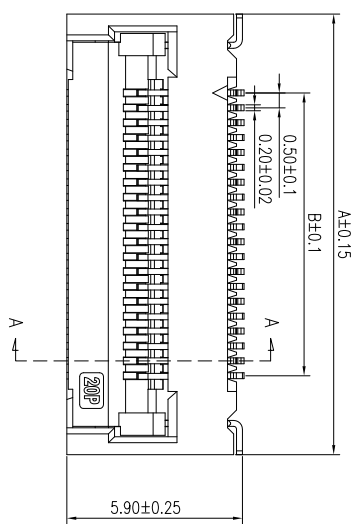

NO. of contacts	Dimensions				No. of contacts	Dimensions			
	A.	B.	C.	D.		A.	B.	C.	D.
4	6.80	1.50	2.57	4.72	33	21.30	16.00	17.07	18.22
5	7.30	2.00	3.07	5.22	34	21.80	16.50	17.57	18.72
6	7.80	2.50	3.57	5.72	35	22.30	17.00	18.07	19.22
7	8.30	3.00	4.07	6.22	36	22.80	17.50	18.57	19.72
8	8.80	3.50	4.57	6.72	37	23.30	18.00	19.07	20.22
9	9.30	4.00	5.07	7.22	38	23.80	18.50	19.57	20.72
10	9.80	4.50	5.57	7.72	39	24.30	19.00	20.07	21.22
11	10.30	5.00	6.07	8.22	40	24.80	19.50	20.57	21.72
12	10.80	5.50	6.57	8.72	41	25.30	20.00	21.07	22.22
13	11.30	6.00	7.07	9.22	42	25.80	20.50	21.57	22.72
14	11.80	6.50	7.57	9.72	43	26.30	21.00	22.07	23.22
15	12.30	7.00	8.07	10.22	44	26.80	21.50	22.57	23.72
16	12.80	7.50	8.57	10.72	45	27.30	22.00	23.07	24.22
17	13.30	8.00	9.07	11.22	46	27.80	22.50	23.57	24.72
18	13.80	8.50	9.57	11.72	47	28.30	23.00	24.07	25.22
19	14.30	9.00	10.07	12.22	48	28.80	23.50	24.57	25.72
20	14.80	9.50	10.57	12.72	49	29.30	24.00	25.07	26.22
21	15.30	10.00	11.07	13.22	50	29.80	24.50	25.57	26.72
22	15.80	10.50	11.57	13.72	51	30.30	25.00	26.07	27.22
23	16.30	11.00	12.07	14.22	52	30.80	25.50	26.57	27.72
24	16.80	11.50	12.57	14.72	53	31.30	26.00	27.07	28.22
25	17.30	12.00	13.07	15.22	54	31.80	26.50	27.57	28.72
26	17.80	12.50	13.57	15.72	55	32.30	27.00	28.07	29.22
27	18.30	13.00	14.07	16.22	56	32.80	27.50	28.57	29.72
28	18.80	13.50	14.57	16.72	57	33.30	28.00	29.07	30.22
29	19.30	14.00	15.07	17.22	58	33.80	28.50	29.57	30.72
30	19.80	14.50	15.57	17.72	59	34.30	29.00	30.07	31.22
31	20.30	15.00	16.07	18.22	60	34.80	29.50	30.57	31.72
32	20.80	15.50	16.57	18.72	61	35.30	30.00	31.07	32.22

**CUSTOMER**  
深圳市文章济美科技有限公司

GENERAL TOLERANCE UNLESS OTHERWISE SPECIFIED  
DRAWN: 康观长  
CHECKER:  
2019.05.29  
PART NO. 5001 - FEZ0559 - \*\*R1 - 00  
TITLE: 0.5Pitch 5.9H 焊 插 连 接 器  
APPROVED: 黄德进  
2019.05.29  
SHEET: 1/1  
UNIT: mm  
SCALE: 1:1  
SIZE: A4  
REV: X1

REV.	REVISIONS	CHK	DATE
XX			
XXX			
XXXX			
AMC.			