

RECOMMENDED PCB LAYOUT(.XX±0.05)  
CONNECTOR SIDE(TOP VIEW)

NOTE:  
 1.MATERIAL AND FINISH SEE THE TABLE.  
 2.MECHANICAL CHARACTERISTICS  
 INSERTION FORCE: 44.1N MAX  
 EXTROCTION FORCE: 5N MIN(AFTER 5000 CYCLES 3N MIN.), 25N MAX.  
 MATING CYCLE:5000 CYCLES  
 3.ELECTRICAL CHARACTERISTICS  
 RATING CURRENT: 0.5A  
 RATING VOLTAGE: 40V  
 CONTACT RESISTANCE: 10 MILLOHMS OHMS MAX (EXCLDUING CONDUCTOR RESISTANCE)  
 INSULATION RESISTANCE:  
 a, UNMATED: 100M OHMS MIN AT 500 VDC  
 b, MATED: 10M OHMS MIN AT 150 VDC  
 DIELECTRIC WITHSTANDING VOLTAGE:  
 250V AC/1MINUTE  
 OPERATING TEMPERATURE: -20°C--+85°C  
 STORAGE TEMPERATURE: -20°C--+65°C

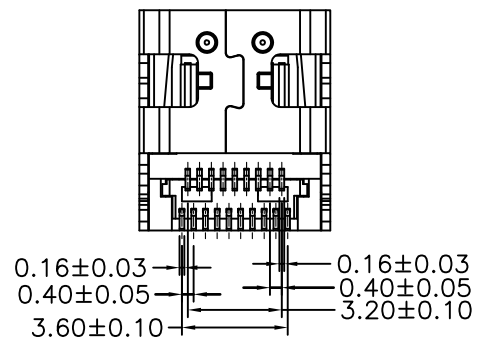
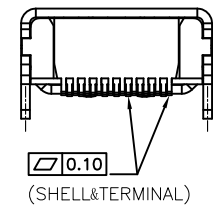
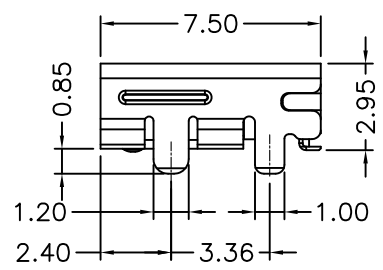
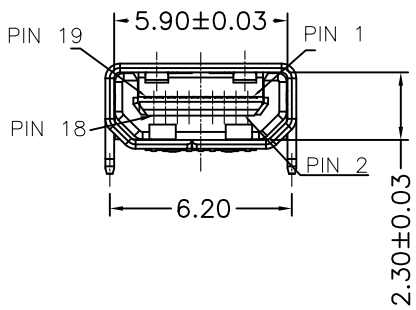

PART NO: 5001-HDMI 01 D -19 R 1-00

- ALTERNATE
- PACKING:R: 卷
- PIN
- D型
- 固定脚: 插件
- 高清座
- JME CONNECTOR SERIES

| PIN | Signal Assignment | PIN | Signal Assignment |
|-----|-------------------|-----|-------------------|
| 1   | Hot Plug Detect   | 2   | Utility           |
| 3   | TMDS Data2+       | 4   | TMDS Data2 Shield |
| 5   | TMDS Data2-       | 6   | TMDS Data1+       |
| 7   | TMDS Data1 Shield | 8   | TMDS Data1-       |
| 9   | TMDS Data0+       | 10  | TMDS Data0 Shield |
| 11  | TMDS Data0-       | 12  | TMDS Clock+       |
| 13  | TMDS Clock Shield | 14  | TMDS Clock-       |
| 15  | CEC               | 16  | DDC/CEC Ground    |
| 17  | SCL               | 18  | SDA               |
| 19  | +5V Power         |     |                   |

|                              |                             |   |               |
|------------------------------|-----------------------------|---|---------------|
| CUSTOMER DRAWING             |                             | 深圳市文章济美科技有限公司                               |               |
| Tolerance Unspecified (未注公差) | Size (图幅): A4               | Product Name (产品名称): HDMI D/F TYPE SMT TYPE |               |
| 0.0 ±0.30 0°. ±5°            | Unit (单位): MM               | SHELL LEG DIP+DIP (HSD-1 Series)            |               |
| 0.00 ±0.20 0°. ±3°           | Scale (比例): 1:1             | Product No (产品料号): 5001-HDMI01D-19R1-00     |               |
| 0.000 ±0.10 0°.00 ±1°        | Project View (投影视角): 1 OF 1 | Designer (设计): Chu                          | Checked (审核): |
| Rev 版本                       | Change Description 变更内容     | Date 日期                                     | Revisor 制/修订人 |
| C                            | 新增电镀规格                      | 2021/08/12                                  | Chu           |
| B                            | 修改麦拉大小, 改模组麦拉               | 2015/06/23                                  | Chu           |
| A                            | 新版发行                        | 2012/03/13                                  | Chu           |
| Rev 版本                       |                             | Date 日期                                     | Revisor 制/修订人 |

|        |                         |            |               |
|--------|-------------------------|------------|---------------|
| Rev 版本 | Change Description 变更内容 | Date 日期    | Revisor 制/修订人 |
| C      | 新增电镀规格                  | 2021/08/12 | Chu           |
| B      | 修改麦拉大小, 改模组麦拉           | 2015/06/23 | Chu           |
| A      | 新版发行                    | 2012/03/13 | Chu           |